

Connecting Elements for Protective Grille Unit
 防护网单元连接组件

Spring Clamping Nut
 夹板弹片

Spring clamping nut has to be used when inserting panels and recommend installing distance is 300mm.
 安装板状物时需配合夹板弹片使用，建议夹板弹片安装距离为300mm。

Material: spring steel
 材质：优质弹簧钢

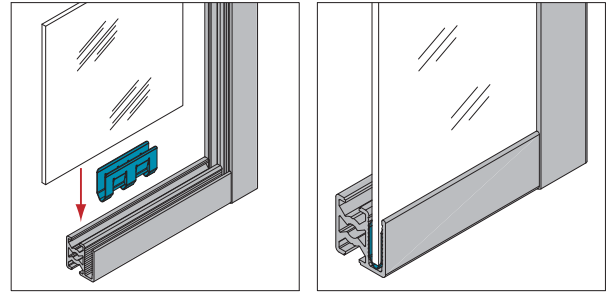
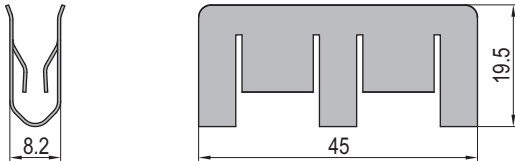

Description 描述	Mass 重量(g)	Part No. 订购编号
Spring Clamping Nut 夹板弹片	7	6.42.01

End Cap for Protective Grille Profile
 防护网型材端盖

To prevent injury and improve end appearance, the bore hole enables assembly of profile and connectors.
 端盖可以预防划伤，使型材更美观。中心孔用于实现型材与螺栓的连接。

Material: Black ABS
 材质：ABS 颜色：黑色

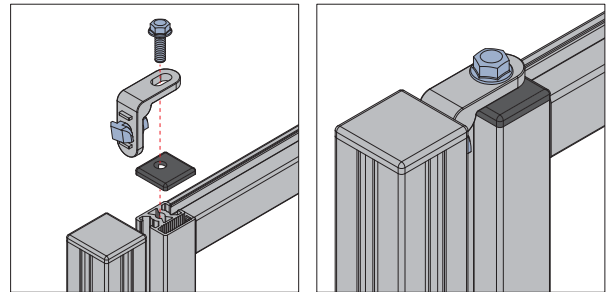
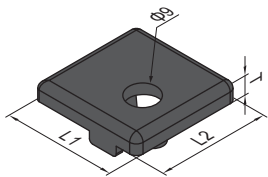

Description 描述	L1 (mm)	L2 (mm)	T (mm)	Mass 重量(g)	Part No. 订购编号
End Cap for Protective Grille Profile- PG30-3030 防护网型材端盖-30系列-3030	40	40	5	4	4.13.30.3030.SM
End Cap for Protective Grille Profile- PG40-4040 防护网型材端盖-40系列-4040				6	4.13.40.4040.SM