

Floor Elements
地面组件

Mounting Plate
支脚连接板





To attach leveling foot or castor to strut profile end.

连接支脚或脚轮与型材端面。

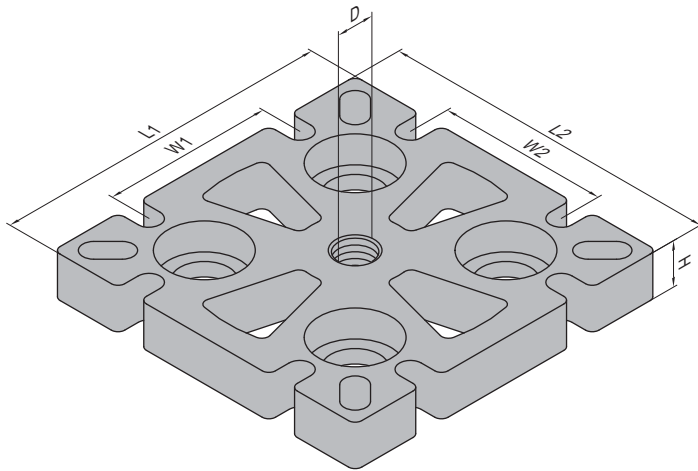
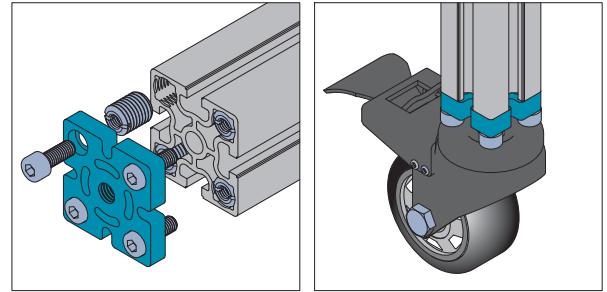
Material: spray coating steel, silver

材质和颜色：碳钢喷涂 银色



FY	Fastening Set	FZ	Fastening Set
	M6x20 Bolt zinc plated		M6x20 Bolt zinc plated
	M16→M8 Hole Reducer Bolt nickel plated		M12→M6 Hole Reducer Bolt nickel plated

Description 产品描述	D	L1 (mm)	L2 (mm)	W1 (mm)	W2 (mm)	H (mm)	Fastening Set 紧固组件	Mass 重量 (g)	Part No. 订购编号
Mounting Plate-PG30-6060 支脚连接板-30系列-6060	M12	60	60	30	30	10	4x FZ	232	5.32.30.6060.M12
	M16							230	5.32.30.6060.M16
Mounting Plate-PG40-8080 支脚连接板-40系列-8080	M12	80	80	40	40	12	4x(M14x25)	534	5.32.40.8080.M12
	M16							532	5.32.40.8080.M16
	M20							530	5.32.40.8080.M20
Mounting Plate-PG45-9090 支脚连接板-45系列-9090	M12	90	90	45	45	12	4x(M14x25)	664	5.32.45.9090.M12
	M16							661	5.32.45.9090.M16
	M20							659	5.32.45.9090.M20
Mounting Plate-PG50-100100 支脚连接板-50系列-100100	M12	100	100	50	50	12	4x(M14x25)	725	5.32.50.100100.M12
	M16							722	5.32.50.100100.M16
	M20							720	5.32.50.100100.M20
Mounting Plate-PG60-6060 支脚连接板-60系列-6060	M12	60	60	40	40	12	4x FY	330	5.32.60.6060

Note: offer per set (including fastening set).

备注：成套供货 (包含紧固组件)。