

Additional Accessories
其他附件

Swivel Angle Plate
角度调节板

Infinitely variable adjusting of inclination with swivel angle.
角度调节板可实现型材间最大角度的调节。
Material and Color: steel, black electrophoresis
材质和颜色: 碳钢 黑色电泳

Swivel Angle Plate-PG30
角度调节板-30系列

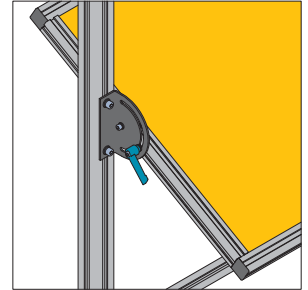
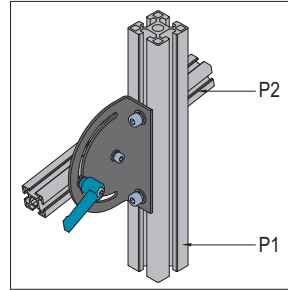
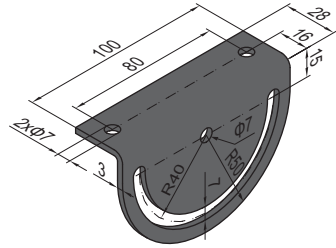

Swivel Angle Plate-PG40/45
角度调节板-40/45系列

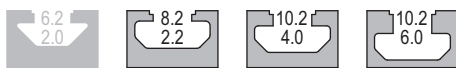
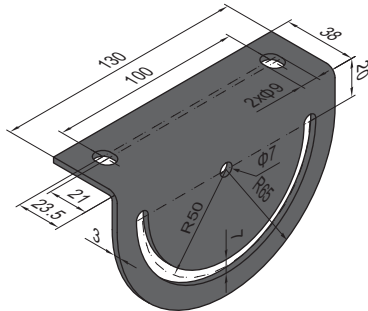

FR	Fastening Set	FT	Fastening Set	FV	Fastening Set	FW	Fastening Set	R	Fastening Set
	M6x12 Adjustable Handle blastic coated, black		M6x12 Bolt zinc plated		M6x16 Bolt zinc plated		M6x16 Bolt zinc plated		M6x12 Bolt zinc plated
	M6 Washer zinc plated		M6 Washer zinc plated		M8 Washer zinc plated		M6 Washer zinc plated		M6 Washer zinc plated
	M6 Pre-set Nut nickel plated		M6 Pre-set Nut nickel plated		M8 T Nut nickel plated		M6 Pre-set Nut nickel plated		M6 T Nut nickel plated

Description 产品描述	P1	P2	Fastening Set 紧固组件	Mass 重量 (g)	Part No. 订购编号
Swivel Angle Plate-PG30 (pcs) 角度调节板-30系列(单个供货)				160	8.21.30
Swivel Angle Plate-PG30 (set) 角度调节板-30系列(成套供货)	PG30 30系列	PG30 30系列	1xFR+1xFT+2xR	270	8.21.30.ST
Swivel Angle Plate-PG40/45 (pcs) 角度调节板-40/45系列(单个供货)				288	8.21.40
Swivel Angle Plate-PG40/45-PG30 (set) 角度调节板-40/45系列-30系列(成套供货)	PG40/45 40/45系列	PG30 30系列	1xFR+1xFT+2xFV	420	8.21.40.30.ST
Swivel Angle Plate-PG40/45-PG40/45 (set) 角度调节板-40/45系列-40/45系列(成套供货)	PG40/45 40/45系列	PG40/45 40/45系列	1xFR+2xFV+1xFW	443	8.21.40.40.ST