

Additional Accessories
其他附件

Telescope Unit **New!**
伸缩装置

Telescope Unit are composed of strut profile, telescopic profile and connecting elements, the stroke of telescope unit is form 50-500mm.

伸缩装置是由基础框架型材、伸缩杆型材和连接组件构成, 伸缩行程范围50-500mm。

Telescope Unit-3030
伸缩装置-3030

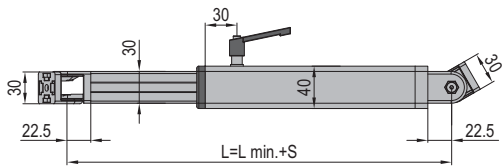

Telescope Unit-3040
伸缩装置-3040

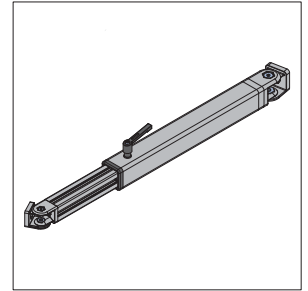
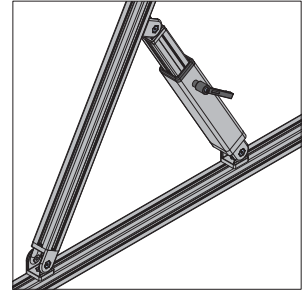
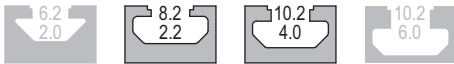
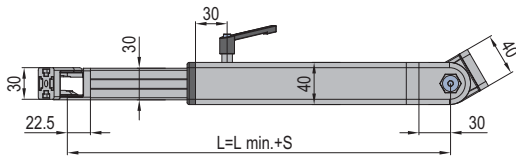

Description 描述	Stroke 行程 S(mm)	L min. (mm)	Mass 重量 (kg)	Part No. 订购编号
Telescope Unit-3030 (set) 伸缩装置-3030 (成套供货)	50≤S≤200	369	1.23	8.61.40.3030.01.ST
	200<S≤350	519	1.43	8.61.40.3030.02.ST
	350<S≤500	669	1.94	8.61.40.3030.03.ST
Telescope Unit-3040 (set) 伸缩装置-3040 (成套供货)	50≤S≤200	377	1.42	8.61.40.3040.01.ST
	200<S≤350	527	1.62	8.61.40.3040.02.ST
	350<S≤500	677	2.13	8.61.40.3040.03.ST

Note: Offer per set. If there is any special requirement on the stroke, please contact with us.
备注: 伸缩装置成套供货。如对行程有特殊要求请与我司联系。