

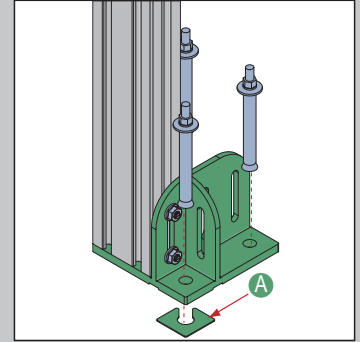

Base Plate 隔断支脚

To support strut profile at the bottom. Expansion bolts chocked into floor can offer a high stability.
隔断支脚用于防护单元之间型材的底部支撑, 使用膨胀螺栓置于地下更能提高稳定性。
Material and surface treatment: cast steel, anti-corrosive
材质: 铸钢 表面处理: 防腐化学



Base Plate 4080
隔断支脚 4080

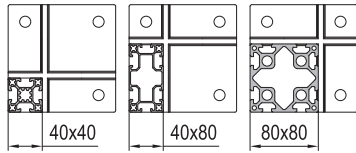
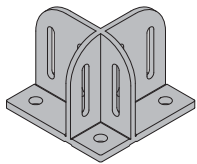

Base Plate 4560
隔断支脚 4560

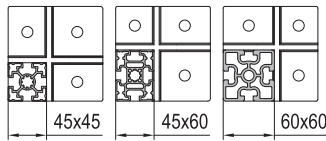
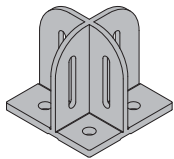

Base Plate 4590
隔断支脚 4590

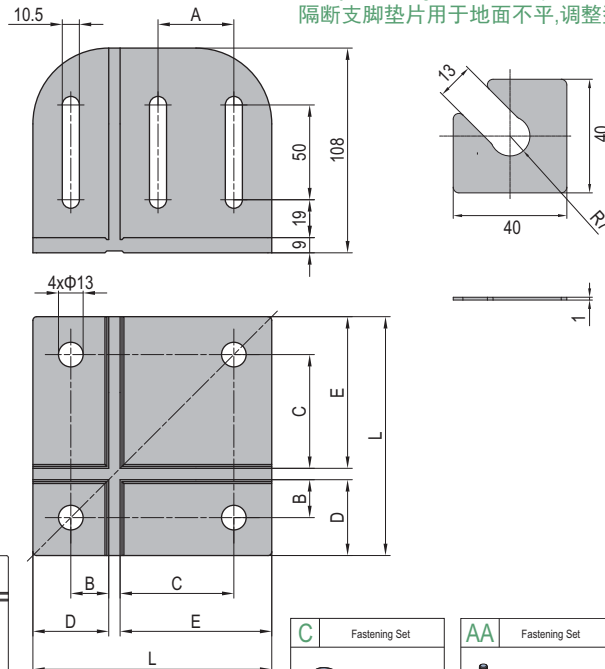
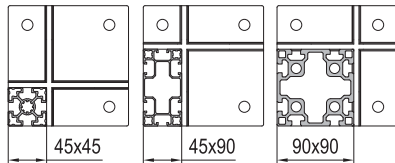
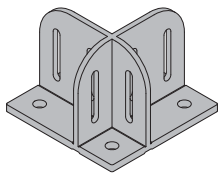

A Base Plate Gasket
隔断支脚垫片

To adjust the degree of vertical profile and uneven ground.
隔断支脚垫片用于地面不平, 调整型材与地面垂直度。

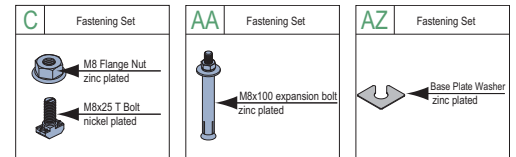

Description 产品描述	L (mm)	A (mm)	B (mm)	C (mm)	D (mm)	E (mm)	Fastening Set 紧固组件	Mass 重量 (g)	Part No. 订购编号
Base Plate-4080 (pcs)/隔断支脚-4080 (单个供货)	126	40	20	60	40	80	2xAZ	1930	5.11.4080
Base Plate-4080 (set A)/隔断支脚-4080 (成套供货A)							4xC+3xAA+2xAZ	2240	5.11.4080.STA
Base Plate-4080 (set B)/隔断支脚-4080 (成套供货B)							6xC+3xAA+2xAZ	2290	5.11.4080.STB
Base Plate-4080 (set C)/隔断支脚-4080 (成套供货C)							8xC+3xAA+2xAZ	2340	5.11.4080.STC
Base Plate-4560 (pcs)/隔断支脚-4560 (单个供货)	111		22.5	30	45	60	2xAZ	1600	5.11.4560
Base Plate-4560 (set)/隔断支脚-4560 (成套供货)							4xC+3xAA+2xAZ	1910	5.11.4560.ST
Base Plate-4590 (pcs)/隔断支脚-4590 (单个供货)	141	45	22.5	67.5	45	90	2xAZ	2330	5.11.4590
Base Plate-4590 (set A)/隔断支脚-4590 (成套供货A)							4xC+3xAA+2xAZ	2640	5.11.4590.STA
Base Plate-4590 (set B)/隔断支脚-4590 (成套供货B)							6xC+3xAA+2xAZ	2690	5.11.4590.STB
Base Plate-4590 (set C)/隔断支脚-4590 (成套供货C)							8xC+3xAA+2xAZ	2740	5.11.4590.STC
Base Plate Gasket/隔断支脚垫片 A								9	5.11.01

