

Fastening Elements
紧固件

Subsequent Nut
后置弹片螺母

Subsequent Nut with a spring leaf can be inserted directly at the assembly point. The spring assists with assembly and positioning. The connecting strength and stability is the same as t nut.

后置弹片螺母不仅可以从型材T形槽外部直接置入槽内，还能依靠弹片的弹力保持其在槽内位置，连接强度和可靠性与T形螺母相当。

Material: zinc plated steel
材质：碳钢镀锌

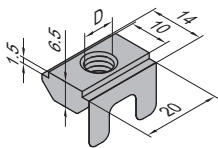
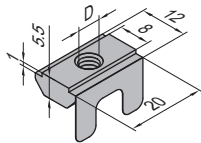
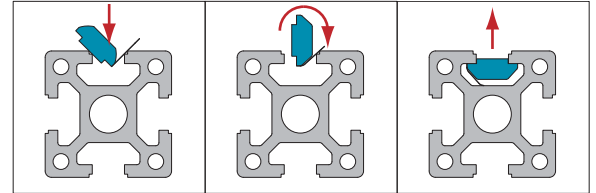
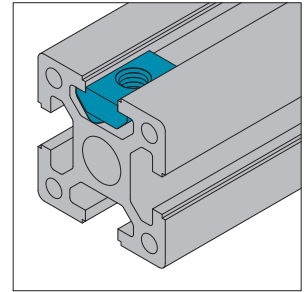

Description 产品描述	D	Material 材质	Mass 重量 (g/pcs)	订购编号 Part No.
Subsequent Nut -8-M4 后置弹片螺母-8-M4	M4	zinc plated steel 碳钢镀锌	5	2.31.08.M4
Subsequent Nut -8-M5 后置弹片螺母-8-M5	M5	zinc plated steel 碳钢镀锌	5	2.31.08.M5
Subsequent Nut -8-M6 后置弹片螺母-8-M6	M6	zinc plated steel 碳钢镀锌	5	2.31.08.M6
Subsequent Nut -8-M8 后置弹片螺母-8-M8	M8	zinc plated steel 碳钢镀锌	5	2.31.08.M8

Description 产品描述	D	Material 材质	Mass 重量 (g/pcs)	订购编号 Part No.
Subsequent Nut -10-M4 后置弹片螺母-10-M4	M4	zinc plated steel 碳钢镀锌	8	2.31.10.M4
Subsequent Nut -10-M5 后置弹片螺母-10-M5	M5	zinc plated steel 碳钢镀锌	8	2.31.10.M5
Subsequent Nut -10-M6 后置弹片螺母-10-M6	M6	zinc plated steel 碳钢镀锌	8	2.31.10.M6
Subsequent Nut -10-M8 后置弹片螺母-10-M8	M8	zinc plated steel 碳钢镀锌	8	2.31.10.M8