

Connecting Elements  
连接件

Angle Profile Bracket  
挤压角铝

Material: aluminium, anodized (cutting end not anodized)  
材质: 铝合金, 表面阳极氧化 (切面无处理)

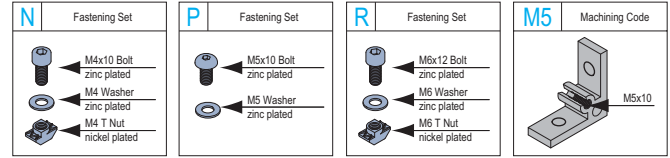

35x35x4

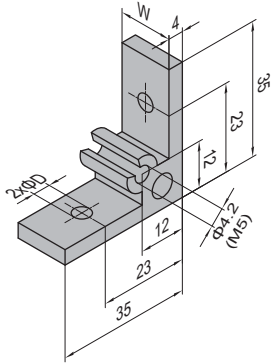

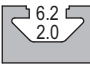
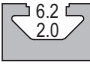
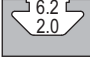
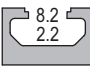
Application 应用	Description 产品描述	D (mm)	W (mm)	Fastening Set 紧固组件	Machining Code 加工代码	Mass 重量 (g)	Part No. 订购编号
PG15 15mm 	35-15-15 (pcs/单个供货)	4.5	10			8	3.31.35.15.15
	35-15-15 (set/成套供货)	4.5	10	2xN		20	3.31.35.15.15.ST
	35-15-15 (M5/加工供货)	4.5	10		M5	8	3.31.35.15.15.M5
	35-15-15 (M5 set/成套加工供货)	4.5	10	2xN+1xP	M5	22	3.31.35.15.15.M5.ST
PG15 30mm 	35-15-30 (pcs/单个供货)	4.5	25			21	3.31.35.15.30
	35-15-30 (set/成套供货)	4.5	25	2xN		33	3.31.35.15.30.ST
	35-15-30 (M5/加工供货)	4.5	25		M5	21	3.31.35.15.30.M5
	35-15-30 (M5 set/成套加工供货)	4.5	25	2xN+1xP	M5	35	3.31.35.15.30.M5.ST
PG20 20mm 	35-20-20 (pcs/单个供货)	4.5	14			12	3.31.35.20.20
	35-20-20 (set/成套供货)	4.5	14	2xN		24	3.31.35.20.20.ST
	35-20-20 (M5/加工供货)	4.5	14		M5	12	3.31.35.20.20.M5
	35-20-20 (M5 set/成套加工供货)	4.5	14	2xN+1xP	M5	26	3.31.35.20.20.M5.ST
PG30 30mm 	35-30-30 (pcs/单个供货)	6.5	22			19	3.31.35.30.30
	35-30-30 (set/成套供货)	6.5	22	2xR		42	3.31.35.30.30.ST
	35-30-30 (M5/加工供货)	6.5	22		M5	19	3.31.35.30.30.M5
	35-30-30 (M5 set/成套加工供货)	6.5	22	2xR+1xP	M5	44	3.31.35.30.30.M5.ST