

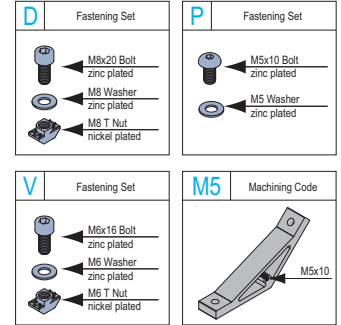

Connecting Elements
连接件

Angle Profile Bracket
挤压角铝

Material: aluminium, anodized (cutting end not anodized)
材质: 铝合金, 表面阳极氧化 (切面无处理)

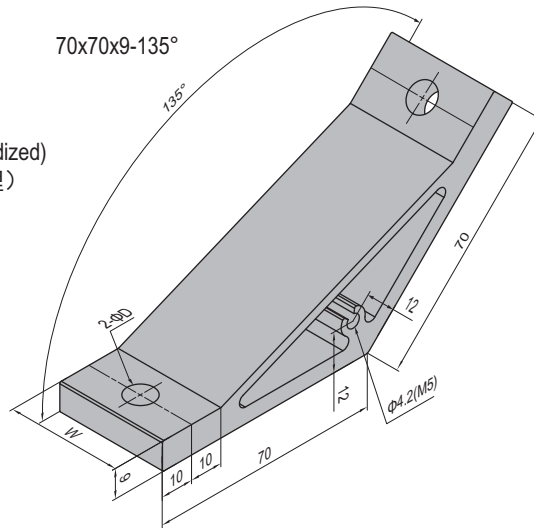
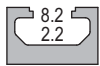
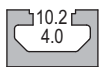
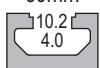
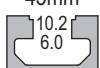
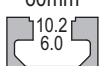

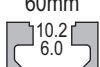
Application 应用	Description 产品描述	D (mm)	W (mm)	Fastening Set 紧固组件	Machining Code 加工代码	Mass 重量 (g)	Part No. 订购编号
PG30 30mm 	70-30-30 (pcs/单个供货)	7	22			71	3.31.70.30.30
	70-30-30 (set/成套供货)	7	22	2xV		94	3.31.70.30.30.ST
	70-30-30 (M5/加工供货)	7	22		M5	71	3.31.70.30.30.M5
	70-30-30 (M5 set/成套加工供货)	7	22	2xV+1xP	M5	96	3.31.70.30.30.M5.ST
PG40 40mm 	70-40-40 (pcs/单个供货)	9	30			96	3.31.70.40.40
	70-40-40 (set/成套供货)	9	30	2xD		142	3.31.70.40.40.ST
	70-40-40 (M5/加工供货)	9	30		M5	96	3.31.70.40.40.M5
	70-40-40 (M5 set/成套加工供货)	9	30	2xD+1xP	M5	144	3.31.70.40.40.M5.ST
PG40 60mm 	70-40-60 (pcs/单个供货)	9	50			166	3.31.70.40.60
	70-40-60 (set/成套供货)	9	50	2xD		212	3.31.70.40.60.ST
	70-40-60 (M5/加工供货)	9	50		M5	166	3.31.70.40.60.M5
	70-40-60 (M5 set/成套加工供货)	9	50	2xD+1xP	M5	214	3.31.70.40.60.M5.ST
PG45 45mm 	70-45-45 (pcs/单个供货)	9	35			113	3.31.70.45.45
	70-45-45 (set/成套供货)	9	35	2xD		159	3.31.70.45.45.ST
	70-45-45 (M5/加工供货)	9	35		M5	113	3.31.70.45.45.M5
	70-45-45 (M5 set/成套加工供货)	9	35	2xD+1xP	M5	161	3.31.70.45.45.M5.ST
PG45 60mm 	70-45-60 (pcs/单个供货)	9	50			166	3.31.70.45.60
	70-45-60 (set/成套供货)	9	50	2xD		212	3.31.70.45.60.ST
	70-45-60 (M5/加工供货)	9	50		M5	166	3.31.70.45.60.M5
	70-45-60 (M5 Set/成套加工供货)	9	50	2xD+1xP	M5	214	3.31.70.45.60.M5.ST
PG50 50mm 	70-50-50 (pcs/单个供货)	9	40			131	3.31.70.50.50
	70-50-50 (set/成套供货)	9	40	2xD		177	3.31.70.50.50.ST
	70-50-50 (M5/加工供货)	9	40		M5	131	3.31.70.50.50.M5
	70-50-50 (M5 Set/成套加工供货)	9	40	2xD+1xP	M5	179	3.31.70.50.50.M5.ST
PG60 60mm 	70-60-60 (pcs/单个供货)	9	50			166	3.31.70.60.60
	70-60-60 (set/成套供货)	9	50	2xD		212	3.31.70.60.60.ST
	70-60-60 (M5/加工供货)	9	50		M5	166	3.31.70.60.60.M5
	70-60-60 (M5 Set/成套加工供货)	9	50	2xD+1xP	M5	214	3.31.70.60.60.M5.ST